



HARRINGTON COURT ALTYRE ROAD EAST CROYDON, CR0 5LF

£1,250 PCM

** A TOTALLY REFURBISHED ONE DOUBLE BEDROOM FLAT WITHIN WALKING DISTANCE TO EAST CROYDON STATION **

This newly refurbished one bedroom first floor flat benefits from double glazing and has been totally redecorated in the past few weeks. The property also features a new kitchen and bathroom suite, gas central heating by radiators and has been re carpeted throughout.

The property is ideally situated for East Croydon station providing access into Central London along with the Tram link which can get you into the centre of Croydon.

Council tax band B £1,929.26p



TOOMEY
ESTATE AGENTS

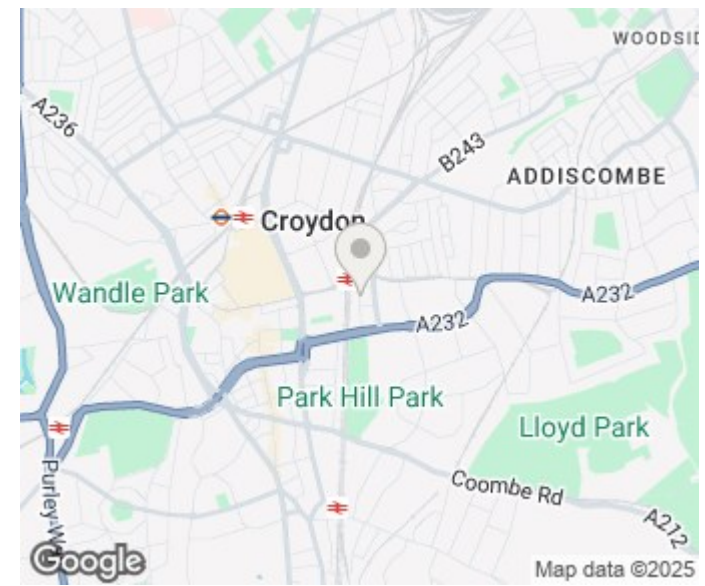
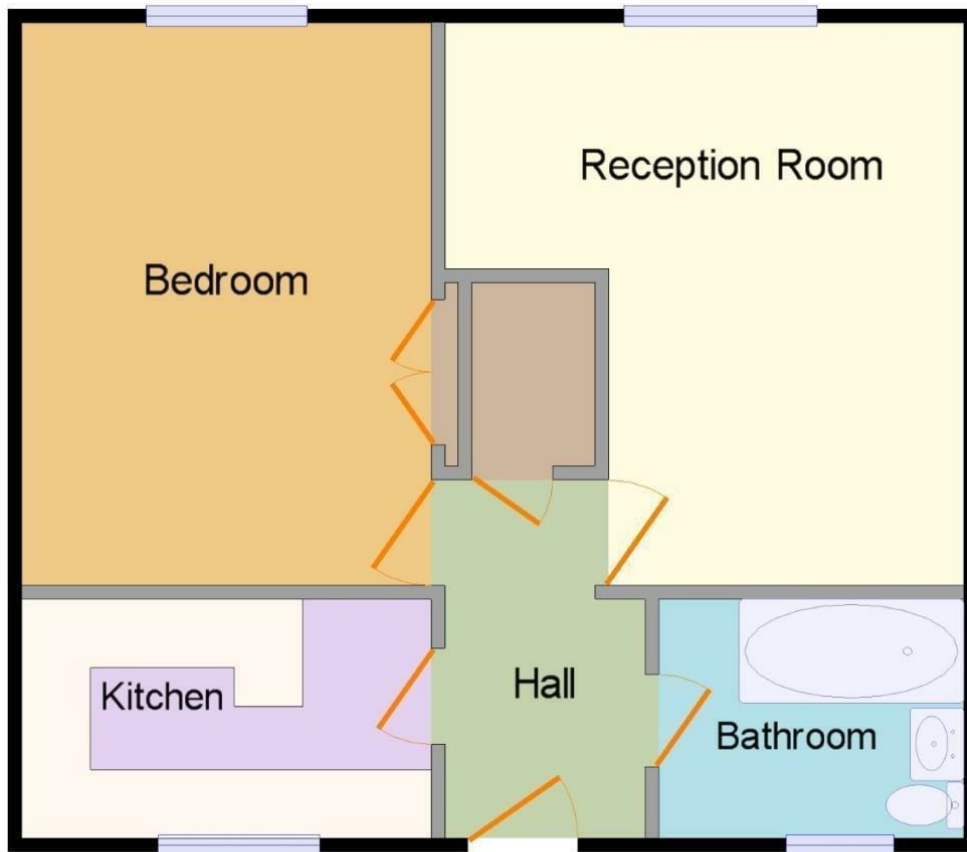

Energy Efficiency Rating		Current	Potential
Very energy efficient - lower running costs			
(92 plus)	A		
(81-91)	B		
(69-80)	C	71	79
(55-68)	D		
(39-54)	E		
(21-38)	F		
(1-20)	G		
Not energy efficient - higher running costs			
England & Wales		EU Directive 2002/91/EC	

Agents Note: Whilst every care has been taken to prepare these particulars, they are for guidance purposes only. All measurements are approximate and are for general guidance purposes only and whilst every care has been taken to ensure their accuracy, they should not be relied upon and potential buyers/tenants are advised to recheck the measurements

Toomey Estate Agents Lettings
 333a London Road
 Mitcham
 Surrey
 CR4 4BE

0208 715 9333
 enquiries@toomeyestateagents.co.uk
 www.toomeyestateagents.co.uk

